



## 10 Howes Crescent, Bishopdown, Salisbury, Wiltshire, SP1 3FU

A superb end terrace family home together with part-walled garden. \*\* THREE BEDROOMS \*\* WEST FACING GARDEN \*\* TWO OFF-ROAD PARKING SPACES \*\*

- END TERRACE
- THREE BEDROOMS
- EN-SUITE SHOWER ROOM
- WEST-FACING GARDEN
- TWO OFF-ROAD PARKING SPACES
- POPULAR RESIDENTIAL SUBURB

**£330,000**

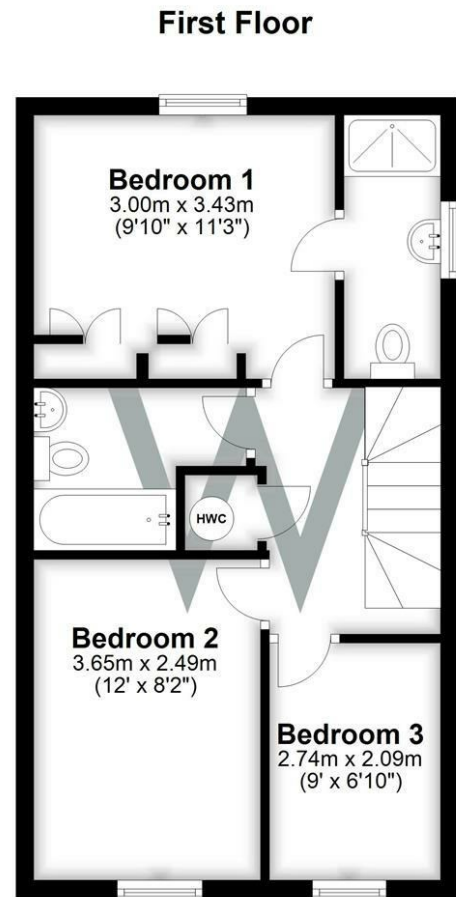
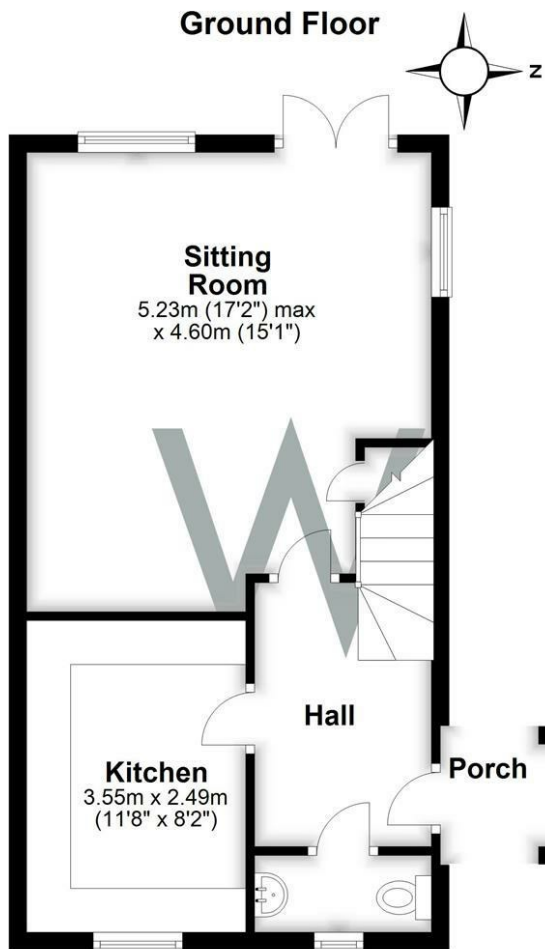

Total area: approx. 82.0 sq. metres (882.6 sq. feet)

**WHITES**

Castle Chambers, 47 Castle Street, Salisbury,  
Wiltshire, SP1 3SP  
Tel: 01722 336422/Option 2  
www.hwwhite.co.uk  
email: lettings-management@hwwhites.co.uk

Energy Efficiency Rating		Current	Potential
Very energy efficient - lower running costs			
(92 plus) <b>A</b>			<b>95</b>
(81-91) <b>B</b>		<b>83</b>	
(69-80) <b>C</b>			
(55-68) <b>D</b>			
(39-54) <b>E</b>			
(21-38) <b>F</b>			
(1-20) <b>G</b>			
Not energy efficient - higher running costs			
<b>England &amp; Wales</b>		EU Directive 2002/91/EC	

Environmental Impact (CO <sub>2</sub> ) Rating		Current	Potential
Very environmentally friendly - lower CO <sub>2</sub> emissions			
(92 plus) <b>A</b>			
(81-91) <b>B</b>			
(69-80) <b>C</b>			
(55-68) <b>D</b>			
(39-54) <b>E</b>			
(21-38) <b>F</b>			
(1-20) <b>G</b>			
Not environmentally friendly - higher CO <sub>2</sub> emissions			
<b>England &amp; Wales</b>		EU Directive 2002/91/EC	